

Tension Link Load Cell

Model XLT

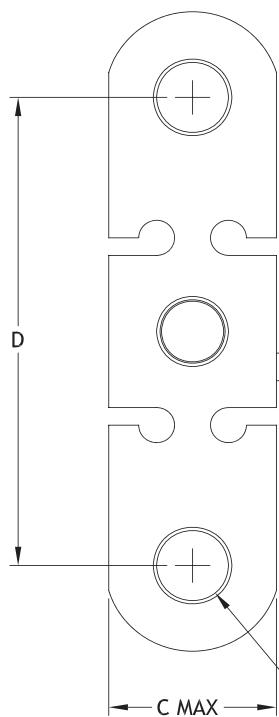
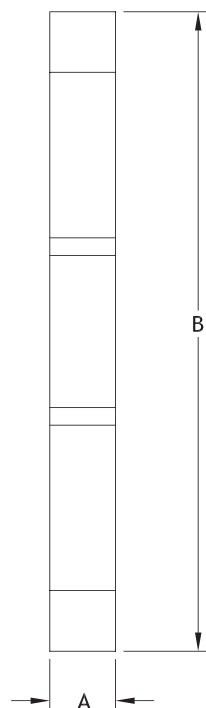

Bendix PTIH-10-6P
or Equal

WIRING CODE/Connector:

PIN A +OUTPUT
PIN B -OUTPUT
PIN C -INPUT
PIN D +INPUT
PIN E NO CONNECTION
PIN F NO CONNECTION

E DIA THRU,
BOTH ENDS



max.
100,000
lbs



Measuring ranges

- 0-10,000 to 0-100,000 lbs



Features

- Structural Strength up to 5x Capacity
- Ease of Installation
- One Piece Design
- Designed for Outdoor Applications
- Used in Overload Protection Devices



Options

- Inline Amplifier
- Size of Loading Holes
- Integral Cable



Drawing

- 99-2790-0000

All dimensions are in inches, unless otherwise noted. Also available in metric units.

PERFORMANCE SPECIFICATIONS (FSO is Full Scale Output)		Ordering Example	A	B	C	D	E	Pin size, Ref.	Rated capacity	Ultimate Overload
LOAD RANGE	10,000 thru 100,000 lbs	XLT2-0125-025K	1.37	13.66	3.5	10.0	1.31	1.25*	25,000 lbs	100,000 lbs
EXCITATION	9 to 15 VDC	XLT4-0150-050K	1.75	15.0	4.25	10.0	1.57	1.50**	50,000 lbs	150,000 lbs
OUTPUT	2 mV/V Nominal									
BRIDGE RESISTANCE	350 Ohms									
LINEARITY										
HYSTERESIS	±0.25% FSO, Combined									
REPEATABILITY										
OPERATING TEMP RANGE	-40 to +260°F (-40 to +125°C)									
COMPENSATED TEMP RANGE	-4 to +160°F (-20 to +70°C)									
THERMAL EFFECTS										
on Zero	±0.75% FSO									
on Span	±0.75% FSO									
SAFE OVERLOAD	150% of Capacity									
MATERIAL	17-4 PH Stainless Steel									

* Available for pin sizes up to 1.75 diameter

** Available for pin sizes up to 2.25 diameter