

Compression Pancake Load Cell

Model XLPC

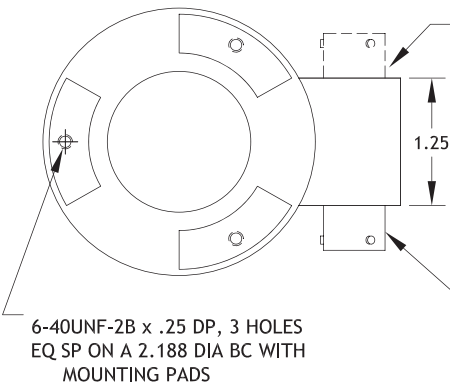
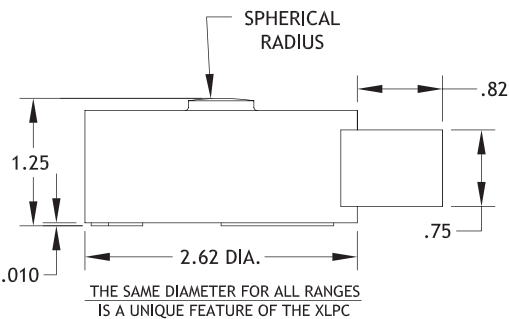

CONNECTOR #2, FOR DUAL BRIDGE OPTION ONLY (ADD "-DB" TO END OF P/N)

BENDIX PTIH-10-6P OR EQUAL
WIRING CODE/Connector:
PIN A +Output
PIN B -Output
PIN C & E -Input
PIN D & F +Input

All dimensions are in inches, unless otherwise noted. Also available in metric units.

PERFORMANCE SPECIFICATIONS (FSO is Full Scale Output)	
EXCITATION	10 VDC, 15 VDC max
OUTPUT	3 mV/V±0.25% FSO
BRIDGE RESISTANCE	350 Ohms
LINEARITY	
3,000 lbs & below	±0.13% FSO
above 3,000 lbs	±0.10% FSO
HYSTERESIS	
3,000 lbs & below	±0.12% FSO
above 3,000 lbs	±0.10% FSO
REPEATABILITY	±0.05% FSO
ZERO BALANCE	±1.0% FSO
OPERATING TEMP RANGE	-65 to +260°F (-54 to +127°C)
COMPENSATED TEMP RANGE	+60 to +160°F (+15 to +71°C)
THERMAL EFFECTS	
on Zero	±0.0025% FSO/°F
on Span	±0.0035% Reading/°F
SAFE OVERLOAD	150% of Capacity
ULTIMATE OVERLOAD	300% of Capacity
MATERIAL	17-4 PH Stainless Steel

Capacity (lbs)	Ordering Example
50	XLPC-0050
1,000	XLPC-001K
10,000	XLPC-010K-DB (Dual bridge option)



max.
10,000
lbs



Measuring ranges

- 25 to 10,000 lbs



Features

- Compression Only
- High Accuracy
- Compact Size
- All Capacities in one Envelope
- Ease of Installation
- Welded Stainless Construction



Options

- Dual Bridge
- Bridge Resistance
- Inline Amplifier
- Integral Cable



Drawing

- 99-3456-0000